

FRONT ELEVATION

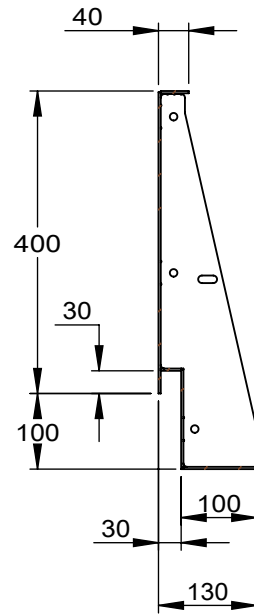

SECTION A-A

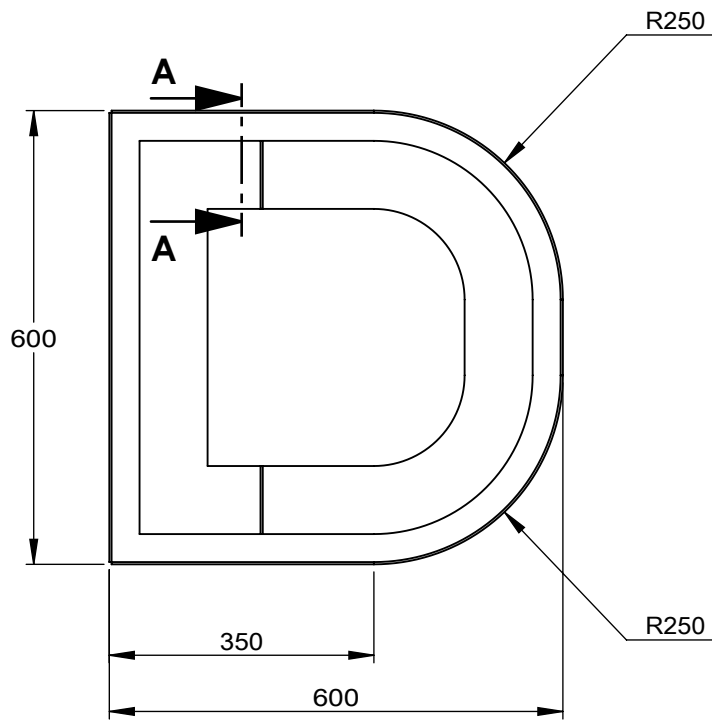

PLAN

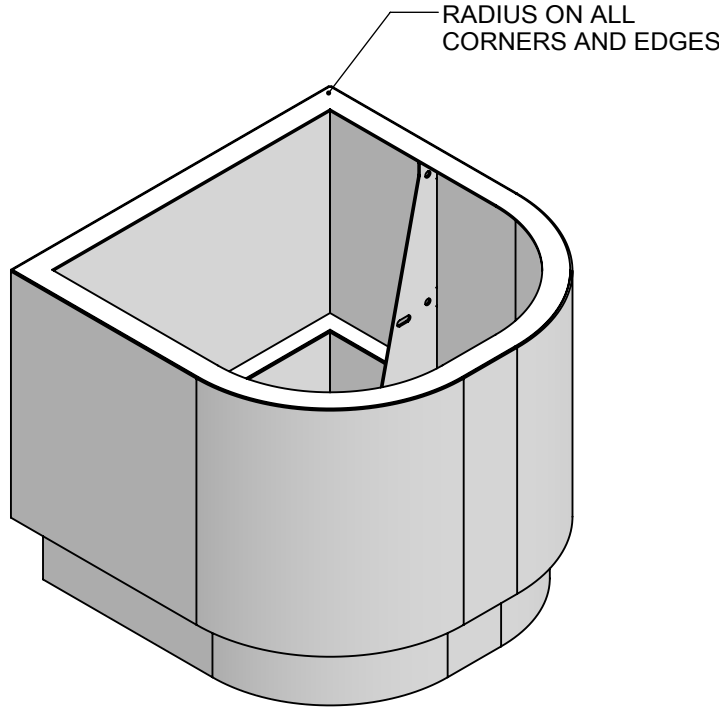

3D VIEW

GENERAL CONRUCTION NOTES

- All Folding Tolerances are  $\pm 1.2\text{mm}$  with an angle variation of  $\pm 1^\circ$
- All Rolling Tolerances  $\pm 8\text{mm}$
- All Fabricated and Welded Components are Manufactured to a Tolerance of  $\pm 2\text{mm}$
- All Fabricated and Welded Corners are Manufactured to a Tolerance of  $\pm 5\text{mm}$  across a Diagonal Measurement
- Were powder coated components are applicable they are completed to the following specification:
  - Pre Treatment – Shot Blast SA 2.5
  - Primer – Zinc Rich primer with a minimum of  $60\mu\text{m}$
  - Top Coat – Final Top coat to be a minimum of  $60\mu\text{m}$
- All Timber finishes are supplied as un-treated
- All Cor-ten finishes are supplied as un-treated/un-weathered

VELIN LIGHT DETAIL

• **TOTAL WEIGHT = 34.63Kg**

REV. **A**

No.1 Old Street  
Clarkenwell  
London  
EC1V 9HL

